



# *Intuitive Specialists*

## *Controlled Remote Viewing*

### **Remote Viewing Summary Report**

### **Session #3CTCCW 128011**

### **What Lies Beneath Mount Shasta?**

*(c) Lori Williams May 2017*

Prior to viewing this target, I was given the following information:

*The target is a Location. Describe the Location.*

Throughout this entire session, which took place over a period of 3 days, I never had a clue what the target was. My first impression was via the [Ideogram](#) was of very steep land, which was:

Rocky  
Grey  
Brown  
Hilly  
Slanted  
Shadowed  
    with shades of light and dark  
    greys and oranges  
Round  
Small  
Numerous  
Partially lit  
Scattered

*(Monitor: Move up 50 feet and describe:)*

Barren  
Open  
Dark



(1)  
Rough  
Rocky  
Orange  
White  
Grey  
Shadowed  
Steep

*(Monitor: Move an appropriate distance beneath the inclined land and describe:)*

Clinking sounds  
White  
Shiny  
Tunneled  
Square  
Concentric  
Pristine  
Well-planned  
Hidden

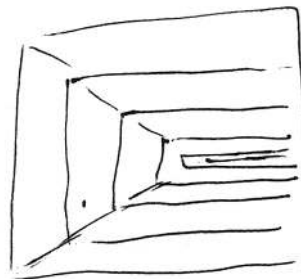

*(Monitor: Move to the "clinking sounds" and describe)*

*(Lori: I am seeing that hilarious scene from Austin Powers when he is in a golf cart sort of thing, stuck horizontally in a narrow white underground hallway, bonking back and forth, trying to get turned around.)*

Clinking Sound:

Mechanical  
Up and down motion  
Cylindrical  
Shiny  
Chrome-colored  
Narrow  
Purposes:  
Functionality  
Motion  
Transportation  
Heating

*(Lori: This place was planned and built.)*

*(Monitor: Move to the builders and describe.)*

Blue

Tall

Thin

Regal

Regimented

Disciplined

Walking in unison

Side by side

Male and Female

Quiet

Shuffling sounds

"Scouted" *(I had the feeling that only the cream of the crop is allowed here, and they are specially chosen to be a part of this.)*

"Cater-walling." *(I don't even really know what that means, but it came, so I wrote it down.)*

Deep underground

Scientific

Militaristic feel

There is a strange bio there...

Spoked. *(The hallways extended out from a central hub, like the spokes of a wheel):*

*See illustration on Page 4*

~militar

Spoked

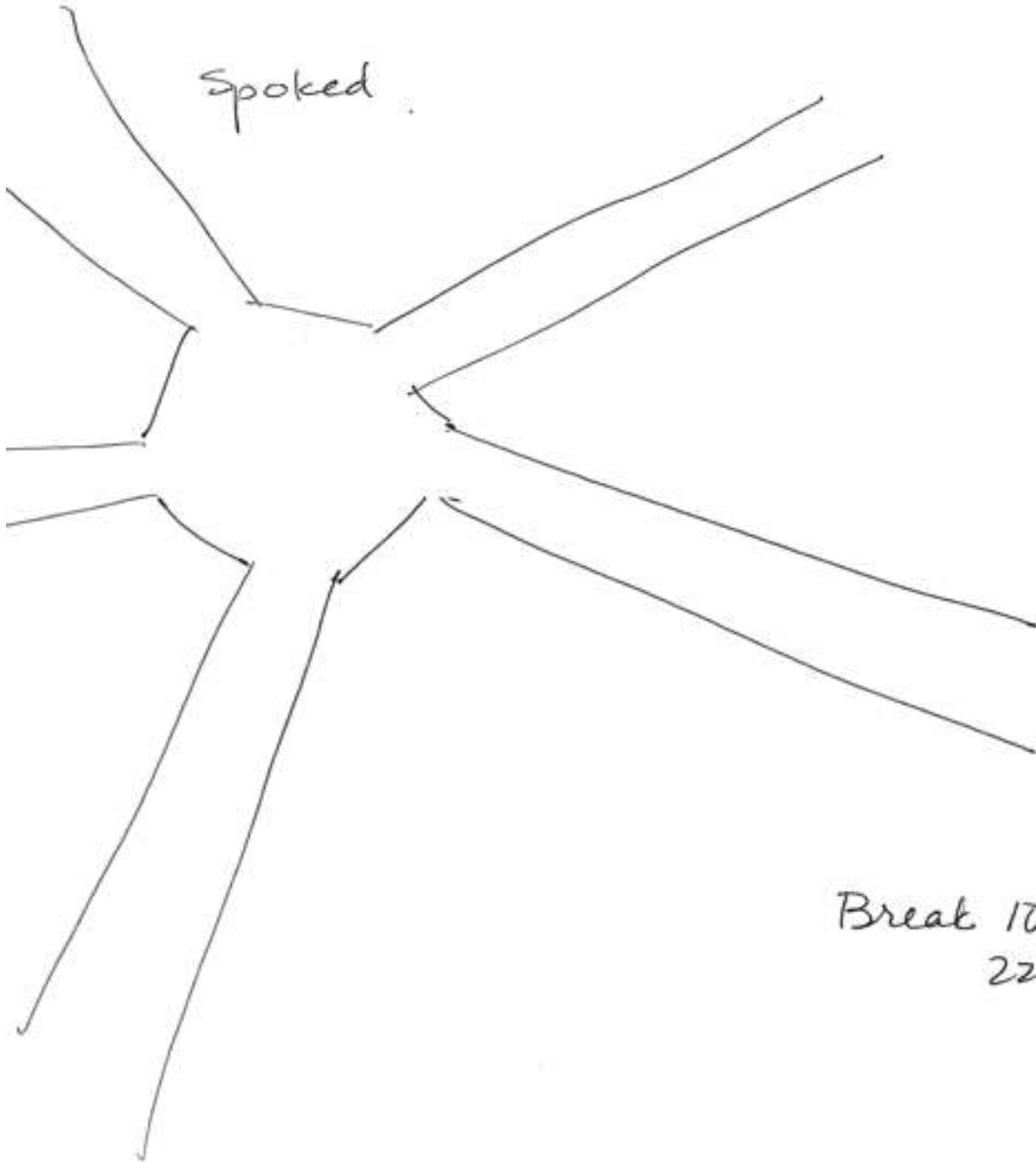

Break 10:  
22:

*(Monitor asks, Move to the "strange bio" and describe.)*

White  
Dark haired  
Male  
Walking  
Stoic  
"There to do a job."  
Vertically positioned  
Thin  
Focused  
Single-minded  
Intense

*(Move to that which the bio is focused on and describe)*

Military  
Experimental  
Scientific  
"Out there" (as in strange or wild!)  
Testing  
Sadistic  
Cruel

The biological being has been found to be:

Cold  
Calculating  
and to him, this all seems "normal" and "all in a day's work."

*(Monitor: Move to the object of the experimentation and describe)*

Helpless  
Alone  
Biological  
Non Human  
Yellow-orange color  
Feels very sad  
    Trapped  
    Against its will  
Hairy  
Furry  
Soft  
Very large  
Strange looking  
Lonely

(Object of Experimentation, continued)

Misses its own kind

Sad

Solitary

One among few

It feels like a rare creature that is being experimented on and held in captivity against its will.

*(Monitor: Move to the end result of the experiment and describe)*

Dark

Fastidious

Cut short

Cataclysmic

No longer viable (It felt as though the creature had expired)

This seemed unexpected by the experimenter, who was surprised.

*(Monitor: Move to the builders (laborers) of this place and describe)*

Several

Male

Huge

Big

Dark-skinned

Large body build

Not very intelligent

(They seemed like "lumbering apes" to me)

Like slaves, overworked laborers.

*(Monitor: Move to the mastermind behind the building of this place and describe.)*

Astute

Wealthy

Very focused

Family linked

*(At this point, I felt the need to summarize what I understood about the target thus far:)*

All of this is part of a bigger plan. This is just a small piece, like a cog in a big machine. This place was constructed for a special use. Very secretive, polished, only the very select are allowed there. Cream of the crop scientists. The goal is so far out there, it is difficult to comprehend. It felt like some sort of "secret underground lair" to me. The purpose of this place is experimentation and exploitation. Everything there is "State of the Art."

*(Monitor: Move to the most important bio there and describe:)*

Powerful  
Male  
White  
Caucasian  
Older  
Grey haired  
Fastidious  
Scientific  
(A "Dr. Who" reference came to mind.)

*(Monitor: Move to the plans and intentions of the bio and describe)*

Colorful  
Serious  
Worldwide  
(At this point, it all seemed very scary to me. To anyone involved there, it seemed:  
All important  
"Life mission"  
All consuming  
Worth giving his life for.  
Involves mankind  
Involves future of...  
To gain power  
To retain power  
To guarantee future for himself and his family.

*(Monitor: Move to the experimentation and describe):*

*(It felt scientific and "out there" in the way that CERN is scientific)*

Scientific  
Complex  
Complicated  
"Over my head."  
Top secret  
Well-guarded  
Yellow  
Human  
Far reaching  
Involving Mankind

*(Monitor: Move to the "involving mankind" and describe):*

Climate-related

*(At this point, I decided to write a quick interim summary, to gather my thoughts about the target:)*

The target involves a location that contains an underground element, which is hidden, and top secret and which involves experimentation that has to do with climate change and the future of the planet and mankind. The area is very mountainous.

This area is very mysterious and has small manmade airborne vehicles that come and go, back and forth, among the mountain tops. It feels as though this is a "fleet" of some sort. These are experimental vessels.

The location itself is:

Cold

Wet

Night time

Dark

Under cover of night

Run by top scientists

Used for security

Preserving...

Concepts of preservation

Future

Food, seeds, etc.

Preparation.



Quick sketch of overall area. The spoked area is underground. The mountains are above, and the craft are also visible as they come and go.

*x INTRIGUED*

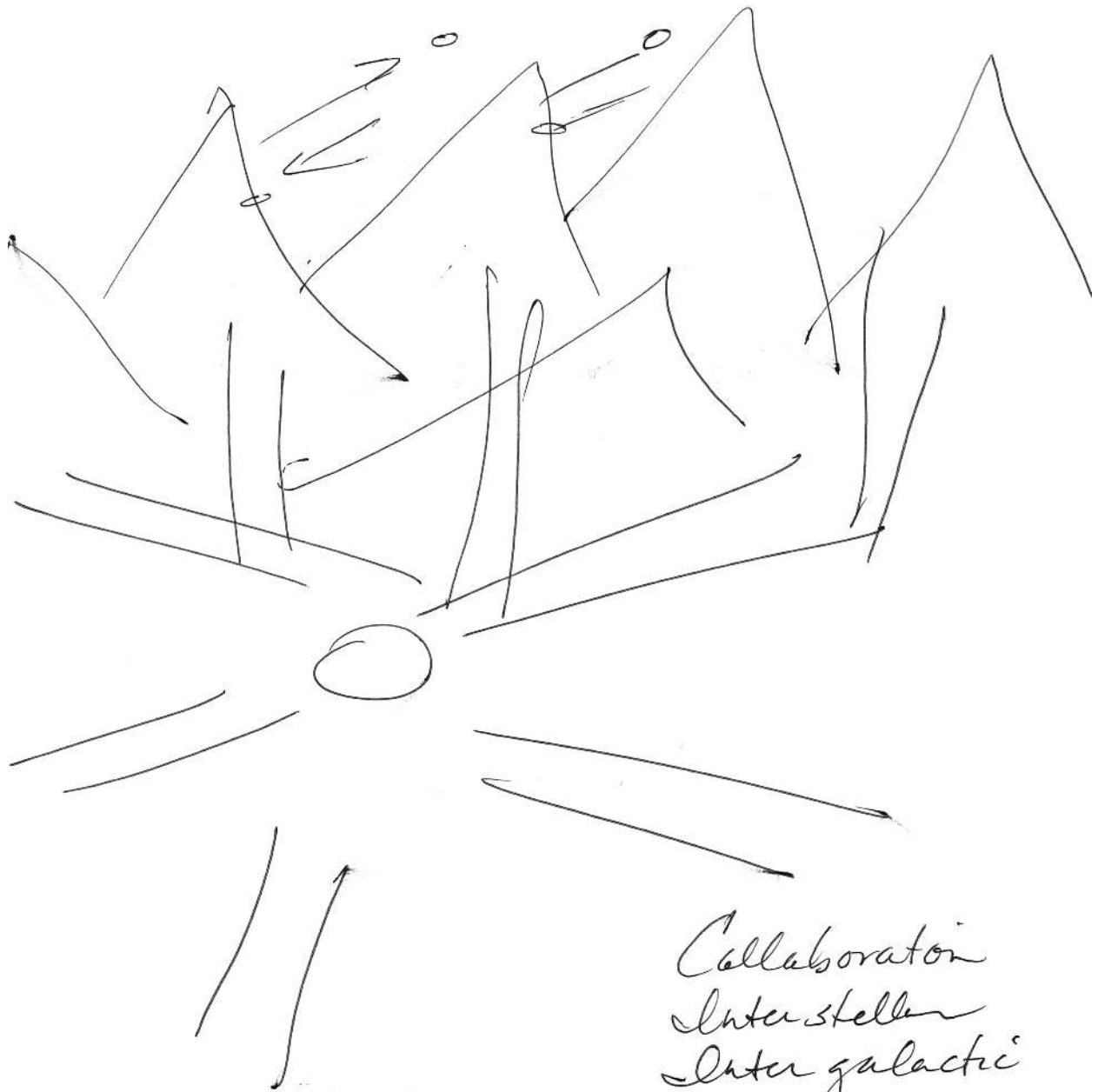

*Collaboration  
Interstellar  
Intergalactic  
collaboration -*

Collaboration  
Interstellar  
Intergalactic  
Collaboration

This area is used for

- Study
- Research
- Protection
- Preservation

It has an ambience which is

- Mysterious
- Futuristic

*(Monitor: Move to the head bio and describe):*

*(I asked mentally, "Is this good or bad for Mankind?")*

Depends on your perspective.

*(I feel very uncomfortable at this point...)*

- Experimentation on human subjects.
- Experimentation on plants.
- Experimentation on seeds.
- Experimentation with food.

Preparation for eventual possible survival in a post-apocalyptic scenario.

This is a "think tank" sort of place.

Very high-tech.

Assisted by higher intelligence

Funded by "big money" -- but this is not *about* Money.

This is about Power.

Again, there were concepts of:

- Science
- Experimentation
- Preservation
- Protection.

*What are they protecting?*

Status Quo

Power

It is not necessarily good for mankind overall.

*(Monitor: Move to what they are protecting from and describe):*

Threat to power  
Any threat to status quo  
Uprisings  
"Awakening the Slaves." *(That was an odd phrase.)*

*(Monitor: Move to the "awakening the slaves" and describe)*

Radical  
Courageous  
Heart-Led  
Spiritual  
Down-to-Earth  
Unafraid  
Pure  
"The Meek Shall Inherit the Earth"

*(At this point, I thought of the YouTube video by Carl Sagan called [Pale Blue Dot](#))*

Perspective  
We are Eternal

*(Monitor: Move to any actions we can take for self-preservation and describe):*

Lori: I don't know...

*(Monitor: What do the Powers that Be fear most?)*

Unity  
Solidarity  
Rational Thinking  
Fearlessness  
Heart-Led People  
Those who will not be silenced  
Changes are coming...  
All good things come to he who waits...  
Embrace each day.  
The Greatest Power is in Love  
And *Their* greatest power is in Fear.

Session End.

**Conclusion:**

This was such a powerful, intense session for me, and there were several times that I was tempted to quit -- to not finish the session and certainly not to share it on the airwaves for millions to see. At the same time, the message seemed very important and very powerful. So I felt compelled to continue, not having any idea what I was seeing or why. I just knew it was an important message. It was fascinating and encouraging to discover that the mountain I remote viewed was Mt. Shasta.